

- Footprint:** 6' x 6'
- Overview:**
  - Open Shelving
  - Lateral Top
  - BF Lateral
  - Tower Storage
  - Boost Monitor Arm
  - Icon

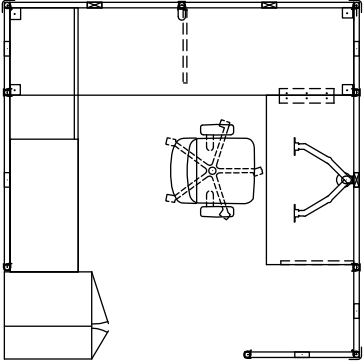

### EQUITY

ITEM	PART DESCRIPTION	QTY	LIST	LINE TOTAL
1	<b>Fabric Panel</b> — Beveled Top – 24W x 49H EP3FA2449K	3	\$773.00	\$2,319.00
2	<b>Fabric Panel</b> — Beveled Top – 30W x 49H EP3FA3049K	1	\$833.00	\$833.00
3	<b>Fabric Panel</b> — Beveled Top – 48W x 49H EP3FA4849K	4	\$1,038.00	\$4,152.00
4	<b>Post Assembly</b> — Beveled Top – End – 49H EP3P49E	2	\$203.00	\$406.00
5	<b>Post Assembly</b> — Beveled Top – “L” – 49H EP3P49L	3	\$184.00	\$552.00
6	<b>Post Assembly</b> — Beveled Top – Straight – 49H EP3P49S	4	\$183.00	\$732.00
7	<b>Add-On Screen</b> — 24W x 15H EP3AOPG2415	3	\$856.00	\$2,568.00
8	<b>Add-On Screen</b> — 30W x 15H EP3AOPG3015	1	\$904.00	\$904.00
9	<b>Add-On Screen</b> — 48W x 15H EP3AOPG4815	4	\$1,166.00	\$4,664.00
10	<b>Worksurface</b> — Straight – 48W x 24D – Scallop EW14824G2	1	\$592.00	\$592.00
11	<b>Worksurface</b> — Straight – 96W x 24D – Scallop EW19624G2	1	\$864.00	\$864.00
12	<b>Cantilever</b> — Left Hand – 20D EB1C20L	1	\$108.00	\$108.00
13	<b>Cantilever</b> — Right Hand – 20D EB1C20R	1	\$108.00	\$108.00
14	<b>Splice Plate</b> — 20" EB1F24	1	\$54.00	\$54.00
15	<b>Panel-to-Worksurface Bracket</b> — Pair (L/R) EB1PWSP	2	\$35.00	\$70.00
			<b>SUB-TOTAL</b>	<b>\$17,960.00</b>

### STORAGE

ITEM	PART DESCRIPTION	QTY	LIST	LINE TOTAL
16	<b>Lateral</b> — BF Shelf – 36W SLATS136	1	\$1,146.00	\$1,146.00
17	<b>Lateral Common Top</b> — 72W x 18D LT72	1	\$612.00	\$612.00
18	<b>Lateral</b> — BF – 36W x 18D – J Pull SLAT136J	1	\$1,399.00	\$1,399.00
19	<b>Tower</b> — Left open – 46H – BBF – J Pull STWR4624BBFLJ	1	\$2,713.00	\$2,713.00
			<b>SUB-TOTAL</b>	<b>\$4,724.00</b>

### ELECTRICAL

ITEM	PART DESCRIPTION	QTY	LIST	LINE TOTAL
20	<b>Jumper</b> — 8-wire – 41 1/2L EE1C48-8	1	\$162.00	\$162.00
21	<b>Jumper</b> — 8-wire – 65 1/2L EE1C72-8	1	\$195.00	\$195.00
22	<b>Duplex Receptacle</b> — Circuit #1 EE1R1	2	\$57.00	\$114.00
23	<b>Duplex Receptacle</b> — Circuit #4 – Dedicated for 3+1, 2+2, 3+3 EE1R4D	1	\$57.00	\$57.00
24	<b>Terminal Block</b> — 8-wire EE1TB-8	3	\$64.00	\$192.00
			<b>SUB-TOTAL</b>	<b>\$720.00</b>

### WORKPLACE ACCESSORIES

ITEM	PART DESCRIPTION	QTY	LIST	LINE TOTAL
25	<b>Boost Monitor Arm</b> — Dual – Silver KCG-110DS	1	\$988.00	\$988.00
			<b>SUB-TOTAL</b>	<b>\$988.00</b>

### SEATING

ITEM	PART DESCRIPTION	QTY	LIST	LINE TOTAL
26	<b>Icon</b> — Weight Sensitive Mech – 3D Arms ICON4633	1	\$908.00	\$908.00
			<b>SUB-TOTAL</b>	<b>\$908.00</b>

**NOTE:** This specification is for budgetary purposes only. Pricing shown is based on lowest grade finishes. Varying options and finishes will affect the pricing. Please consult an authorized Neutral Posture dealer to get actual pricing.

**GRAND TOTAL** **\$26,266.00**